

ALL TIMBER FRAME DETAILS SUBJECT TO APPROVAL FROM TIMBER FRAME SPECIALIST

WALL CONSTRUCTION A:
 White Monocoche Render min 15mm
 100mm medium density concrete block
 60mm cavity (min 50mm)
 Breathable membrane
 9mm plywood
 140x50mm timber studs at 600mm cts
 Provide wall ties at each stud at max 375mm vertical cts (first ties to be 300mm above dpc)
 75mm Kingspan Thermaxwall TW55 zero ODP between studs
 12.5mm pl/bd and skim finish

WALL CONSTRUCTION B:
 White Monocoche Render min 15mm
 100mm medium density concrete block
 60mm cavity (min 50mm)
 Breathable membrane
 9mm plywood
 140x50mm timber studs at 600mm cts
 Provide wall ties at each stud at max 375mm vertical cts (first ties to be 300mm above dpc)
 75mm Kingspan Thermaxwall TW55 zero ODP between studs
 12.5mm pl/bd and skim finish

WALL CONSTRUCTION C:
 White Monocoche Render min 15mm
 100mm medium density concrete block
 60mm cavity (min 50mm)
 Breathable membrane
 9mm plywood
 140x50mm timber studs at 450mm cts
 Provide wall ties at each stud at max 525mm vertical cts (first ties to be 300mm above dpc)
 75mm Kingspan Thermaxwall TW55 zero ODP between studs
 12.5mm pl/bd and skim finish

Cladding at high level as per Wall construction F
 See DETAIL A (16651-06)

REFER TO ELEVATION DRAWINGS FOR POSITIONINGS OF MOVEMENT JOINTS
 REFER TO GENERAL DETAILS FOR INFORMATION ON MOVEMENT JOINTS

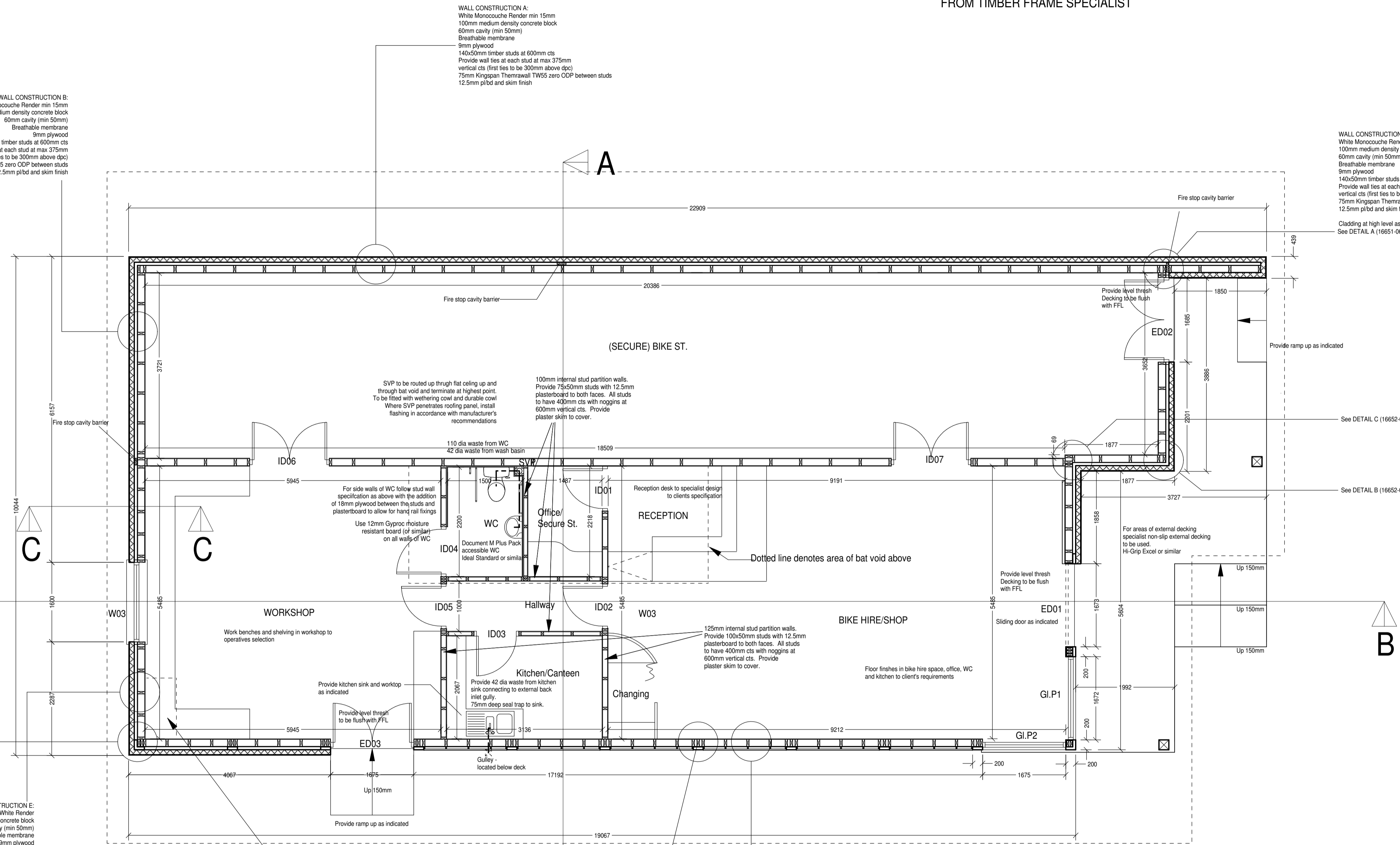

SVP to be routed up through flat ceiling up and through bat void and terminate at highest point. To be filled with weathering cow and durable cow. Where SVP penetrates roofing panel, install flashing in accordance with manufacturer's recommendations

100mm internal stud partition walls. Provide 75x50mm studs with 12.5mm plasterboard to both faces. All studs to have 400mm cts with nogginns at 600mm vertical cts. Provide plaster skim to cover.

Dotted line denotes area of bat void above

125mm internal stud partition walls. Provide 100x50mm studs with 12.5mm plasterboard to both faces. All studs to have 400mm cts with nogginns at 600mm vertical cts. Provide plaster skim to cover.

Floor finishes in bike hire space, office, WC and kitchen to client's requirements

WALL CONSTRUCTION F:
 European / Siberian Larch cladding - 144x25mm (cladding set apart 6-8mm) on 25x44mm inner battens at 600mm cts
 Breathable membrane
 10mm Plywood
 140x50mm timber studs at 450mm cts
 75mm Kingspan Thermaxwall TW55 zero ODP between studs
 Vapour control layer
 18mm Dicon treated plywood boards with negative joints
 * All exposed external timbers (posts and cladding) to have a NON-COM Exterior surface spread of flame protection

ALL TIMBER TO BE TREATED BY ARCH TIMBER PRESERVATION TO ACHIEVE CLASS 0 / CLASS 1 FIRE RESISTANCE LEVELS

Bat Roost 2:
 Bat access to be created on western face of building at high level through sill formed through cladding/Wall build up. Ensure weather tightness at all times. An access slit 15mm by at least 20mm is appropriate as not to allow access for birds. This will lead into a high level boxing located in the south west corner of the workshop to same specification as Bat Roost 1.

BUILDING REGULATIONS / BRITISH STANDARDS
 All works to comply with the current Building Regulations and Approved Documents. All materials and workmanship shall be supplied / installed to current Codes of Practice. The contractor shall carry out his statutory obligations and notify the Local Authority Building Control at the relevant stages of work.

READ IN CONJUNCTION WITH STRUCTURAL ENGINEER'S DRAWINGS. NOTHING ON THESE DRAWINGS TO SUPERCEDE STRUCTURAL ENGINEER'S DRAWINGS. VERIFY ALL STEEL SIZES INDICATED WITH STRUCTURAL ENGINEER'S DESIGN.

ALL FIGURED DIMENSIONS TO BE VERIFIED ON SITE AND CONFIRMED IF NECESSARY WITH STRUCTURAL ENGINEER AND ARCHITECT.

| Rev. | Date | Revision Notes |
|------|------|----------------|
| | | |

Nicholson Nairn Architects owns the copyright of this design & drawing, which must not be reproduced in whole or part without the written permission of Nicholson Nairn Architects.

DO NOT SCALE - ALL DIMENSIONS TO BE VERIFIED ON SITE

NICHOLSON NAIRN ARCHITECTS
 Tel: 0191-420300 Fax: 0191-4200349 Email: admin@nicholsonnairn.co.uk
 Bishops Court, Rectory Lane, Whickham, Newcastle upon Tyne, NE16 4PA
 www.nicholsonnairn.co.uk

| | | |
|---|---------------------|----------------------|
| Client Forestry Commission | | |
| Project Bike Hire Centre | | |
| Address Kielder Forest District, Bellingham | | |
| Scales A1 - 1:50 A3 - 1:100 | Date August 2008 | CAD File CB/16650 |
| Drawing Title Ground Floor Plan | | |
| Drawing No. 16652-01 | Rev. no. - | |

GROUND FLOOR PLAN