

ALL TIMBER FRAME DETAILS SUBJECT TO APPROVAL FROM TIMBER FRAME SPECIALIST

**WALL CONSTRUCTION A:**  
 White Monocoche Render min 15mm  
 100mm medium density concrete block  
 60mm cavity (min 50mm)  
 Breathable membrane  
 9mm plywood  
 140x50mm timber studs at 600mm cts  
 Provide wall ties at each stud at max 375mm vertical cts (first ties to be 300mm above dpc)  
 75mm Kingspan Thermaxwall TW55 zero ODP between studs  
 12.5mm p/bd and skim finish

**WALL CONSTRUCTION B:**  
 White Monocoche Render min 15mm  
 100mm medium density concrete block  
 60mm cavity (min 50mm)  
 Breathable membrane  
 9mm plywood  
 140x50mm timber studs at 600mm cts  
 Provide wall ties at each stud at max 375mm vertical cts (first ties to be 300mm above dpc)  
 75mm Kingspan Thermaxwall TW55 zero ODP between studs  
 12.5mm p/bd and skim finish

**WALL CONSTRUCTION C:**  
 White Monocoche Render min 15mm  
 100mm medium density concrete block  
 60mm cavity (min 50mm)  
 Breathable membrane  
 9mm plywood  
 140x50mm timber studs at 450mm cts  
 Provide wall ties at each stud at max 525mm vertical cts (first ties to be 300mm above dpc)  
 75mm Kingspan Thermaxwall TW55 zero ODP between studs  
 12.5mm p/bd and skim finish

Cladding at high level as per Wall construction F  
 See DETAIL A (16651-06)

REFER TO ELEVATION DRAWINGS FOR POSITIONINGS OF MOVEMENT JOINTS  
 REFER TO GENERAL DETAILS FOR INFORMATION ON MOVEMENT JOINTS

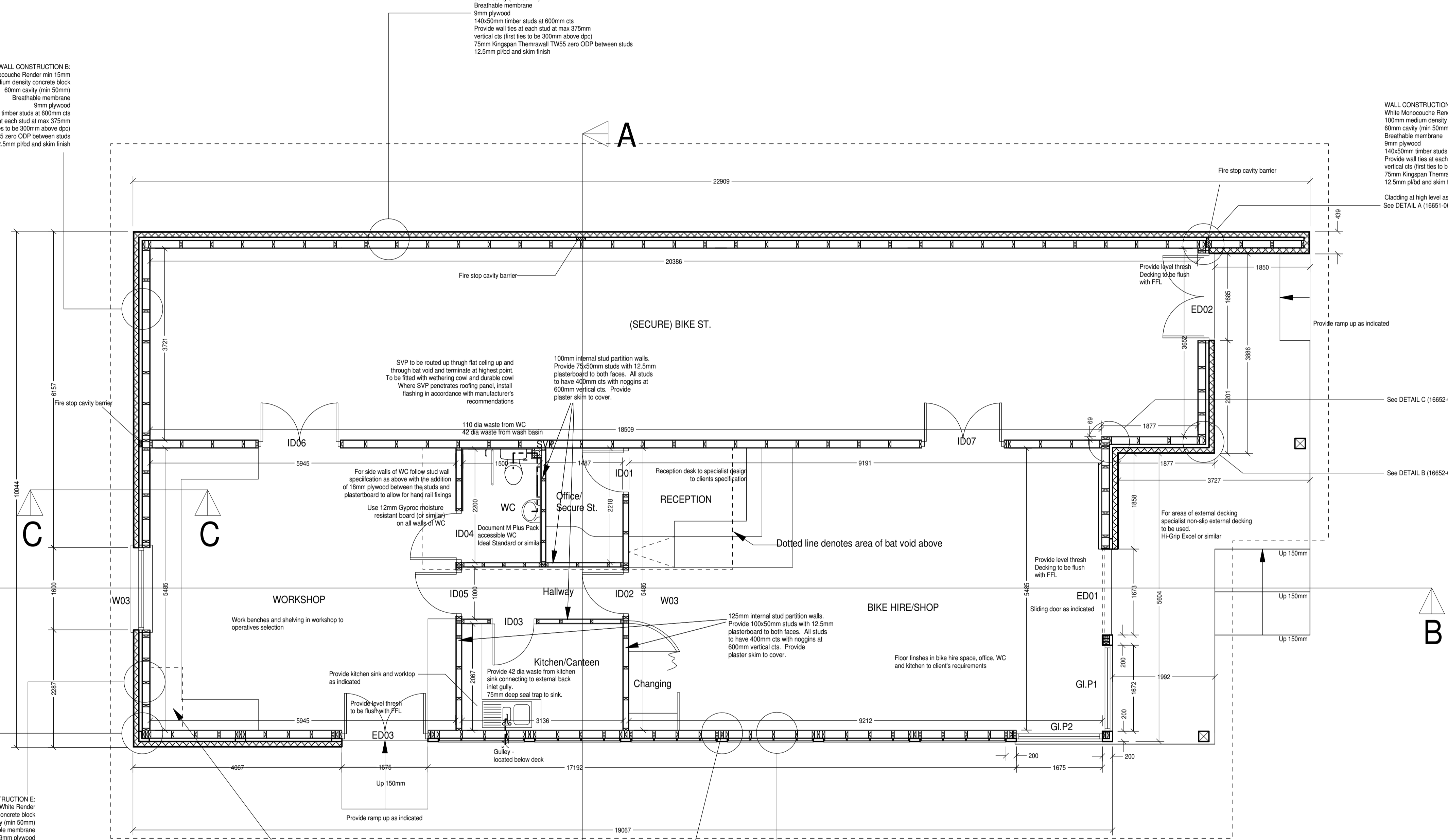

See DETAIL C (16652-06)

See DETAIL B (16652-06)

See DETAIL D (16652-06)

See DETAIL E (16652-06)

See DETAIL E (16652-06)

**WALL CONSTRUCTION F:**  
 European / Siberian Larch cladding - 144x25mm (cladding set apart 6-8mm) on 25x44mm inner battens at 600mm cts  
 Breathable membrane  
 10mm Plywood  
 140x50mm timber studs at 450mm cts  
 75mm Kingspan Thermaxwall TW55 zero ODP between studs  
 Vapour control layer  
 18mm Dicon treated plywood boards with negative joints  
 \* All exposed external timbers (posts and cladding) to have a NON-COM Exterior surface spread of flame protection

ALL TIMBER TO BE TREATED BY ARCH TIMBER PRESERVATION TO ACHIEVE CLASS 0 / CLASS 1 FIRE RESISTANCE LEVELS

**Bat Roost 2:**  
 Bat access to be created on western face of building at high level through sill formed through cladding/Wall build up. Ensure weather tightness at all times. An access slit 15mm by at least 20mm is appropriate as not to allow access for birds. This will lead into a high level boxing located in the south west corner of the workshop to same specification as Bat Roost 1.

**BUILDING REGULATIONS / BRITISH STANDARDS**  
 All works to comply with the current Building Regulations and Approved Documents. All materials and workmanship shall be supplied / installed to current Codes of Practice. The contractor shall carry out his statutory obligations and notify the Local Authority Building Control at the relevant stages of work.

READ IN CONJUNCTION WITH STRUCTURAL ENGINEER'S DRAWINGS. NOTHING ON THESE DRAWINGS TO SUPERCEDE STRUCTURAL ENGINEER'S DRAWINGS. VERIFY ALL STEEL SIZES INDICATED WITH STRUCTURAL ENGINEER'S DESIGN.

ALL FIGURED DIMENSIONS TO BE VERIFIED ON SITE AND CONFIRMED IF NECESSARY WITH STRUCTURAL ENGINEER AND ARCHITECT.

Rev.	Date	Revision Notes

Nicholson Nairn Architects owns the copyright of this design & drawing, which must not be reproduced in whole or part without the written permission of Nicholson Nairn Architects.

DO NOT SCALE - ALL DIMENSIONS TO BE VERIFIED ON SITE

**NICHOLSON NAIRN ARCHITECTS**  
 Tel: 0191-420300 Fax: 0191-4200349 Email: admin@nicholsonnairn.co.uk  
 Bishops Court, Rectory Lane, Whickham, Newcastle upon Tyne, NE16 4PA  
 www.nicholsonnairn.co.uk

Client Forestry Commission		
Project Bike Hire Centre		
Address Kielder Forest District, Bellingham		
Scales A1 - 1:50 A3 - 1:100	Date August 2008	CAD File CB/16650
Drawing Title Ground Floor Plan		
Drawing No. <b>16652-01</b>	Rev. no. -	

# GROUND FLOOR PLAN