

# Salcey Forest

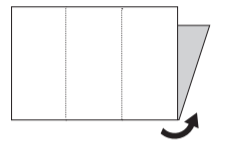

Zoom in of central area overleaf

Fold this guide to pocket size...



1. With this side of the guide facing you, fold bottom half under using dotted lines either side as a guide.

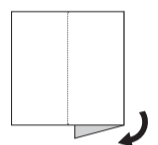

2. Using the dotted line on the top green strip, fold right hand side under.

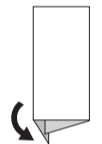

3. Using the dotted line on the top green strip, fold left hand side under.

## Key to map

- Cycle Trail
- Horse Trail
- Woodpecker Trail
- Church Path Walk
- Elephant Walk
- Tree Top Way
- Byway open to all traffic
- Bridleway
- Footpath
- Forest rides
- Public roads
- M1
- Picnic area
- Play area
- Parking
- Information
- Cafe
- Horse Boxing Point

# Welcome to Salcey Forest



Enjoy Salcey on foot, bike, horseback or 20 metres up in the air...

While you are here make sure you visit the **Tree Top Way**. This is an innovative structure made from oak grown in local woodlands. The walkway gently rises up to 15 metres, with a tower at the end that is 20 metres high, from which you can view the woodland and surrounding area. You can see as far as Northampton, Wellingborough and beyond.

## Walking trails

All trails start from the main car parking area

### The Elephant Walk

This is an easy-access route for wheelchairs and pushchairs on level, surfaced ground. The walk is named after the Elephant Pond. During the Second World War, these massive beasts used the pond to cool off while taking a rest from extracting timber from the forest.

The Elephant Bridge crosses the Elephant Pond, which leads you onto the Tree Top Way.

Follow the **purple** bands on the waymarker posts.

### The Church Path Trail

A circular route, about a mile and a half in length. It includes a short section of boardwalk, which passes over sensitive archaeological features (medieval wood banks). It leads you to the Church Path Oak, one of Salcey's famous 'druid oaks', which is thought to be

around 400 years old. The tree finally fell in 1995. This route follows mainly level ground, but can be wet and muddy after rain – appropriate footwear should be worn.

Follow the **orange** bands on the waymarker posts.

### The Woodpecker Trail

This a six-mile route that circles the whole of the forest. Along the way you might see all three British species of woodpecker: the lesser spotted, greater spotted, and green. The trail uses a combination of surfaced and unsurfaced routes, and walking boots are recommended. The trail also shares part of its route with Salcey's horse riding and family cycling routes.

Follow the **blue** bands on the waymarker posts.

## Cycling trails

Cyclists are welcome to use the circular Salcey Forest **Cycle Trail**. This follows a gentle five mile route around the woodlands, starting and finishing in the main car park. Care is needed as the route includes two road crossings. Part of the route is shared with horse-riders and walkers.

Off-road mountain biking is not permitted, because of the sensitive woodland plants associated with this ancient forest.

## Horse riding

Horse riders are welcome. Riders may enter the wood on any of the public bridleways, or use the horse-boxing point at the south-eastern side of the forest, on the edge of Rose Coppice.

The five mile **horse-riding trail** makes a circuit of the forest on open ridings. Care is needed, as there are four public roads crossing the route. Some sections are also shared with the family cycle trail.

**Please do not ride along the easy-access path (the Elephant Walk).**

## Salcey Forest central area



### Key to map

- ● ● Cycle Trail
- ● ● Horse Trail
- ● ● Woodpecker Trail
- ● ● Church Path Walk
- ● ● Elephant Walk
- ~ Tree Top Way
- Bridleway
- Forest rides
- Public roads
- ☞ Picnic area
- ☞ Play area
- P Parking
- i Information
- ☞ Cafe

## Wildlife at Salcey

As you wander, you may catch glimpses of shy fallow deer, or foxes. You might even find empty hazelnut shells left behind by dormice. In spring, carpets of bluebells are spread under the native trees, including ash and field maple. Rare species like the wood white butterfly find a haven here. Part of the wood has been made a Site of Special Scientific Interest, due to the rarity of its wildlife habitats.



## Find out more...

If you want to find out more about Salcey Forest, buy a copy of **Secret Salcey** from the leaflet dispenser on the front of the toilet block. For just £3 you can learn about the colourful history of Salcey, and follow the Time Line to see what was going on here hundreds of years ago. You can also find out what plants and animals live here, and what you can spot each month, as the year unfolds.



## If you have enjoyed your day at Salcey Forest... why not visit Top Lodge Fineshade Woods?

You will find **Top Lodge Fineshade Woods** in the heart of the ancient Rockingham Forest

Explore the trails to find out why Fineshade Wood was a hive of industry in the past. See if you can spot deer and red kites. Relax and enjoy local food and drinks in the Lodge Cafe in Top Lodge visitor centre.

Catch up with woodland wildlife and buy gifts in the RSPB shop. Look out for regular craft fairs held in Top Lodge courtyard.

**Location**  
Signposted 'Fineshade, Top Lodge' on the A43 between Corby and Stamford.  
**Opening times**  
Car parks open 10am – 7pm. Pay & Display parking.  
**Top Lodge Visitor Centre**  
Open daily, 10am – 5pm.

## Salcey Forest visitor information

### Opening times

Car parks open 7am – 7pm summer. 7am – 4pm winter. Pay & Display parking.

### Forest Cafe

Open daily, 10am – 5pm summer. 10am – 4pm winter.

### Forestry Commission England local office

Top Lodge, Fineshade, Near Corby, Northants NN17 3BB.  
e: northants@forestry.gsi.gov.uk t: 01780 444920

» [www.forestry.gov.uk/salceyforest](http://www.forestry.gov.uk/salceyforest)

